



SunSauna

Kotikylpylä

Glass wall installation guide Half-glazed wall

Sun Sauna Oy
Kuormaajantie 40
40320 Jyväskylä
puh. 040 3470220
info@sunsauna.fi

1. Ceiling panelling

The upper edge of the glass wall is normally a flush-mounted glass moulding strip. This facilitates the installation of side glazing and prevents light from penetrating between the glass and the lengthwise panelling.

A 20-25mm wide groove is left in the panelling for the moulding strip. The moulding is fixed by its base to the vapour barrier with screws for reinforcement.

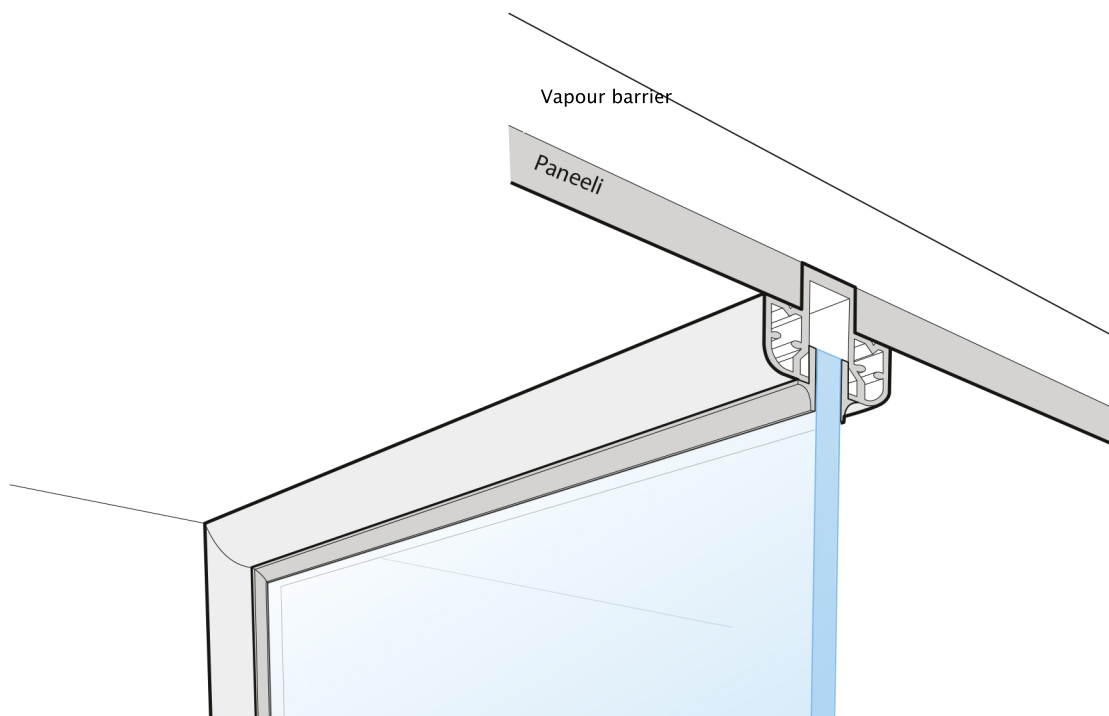
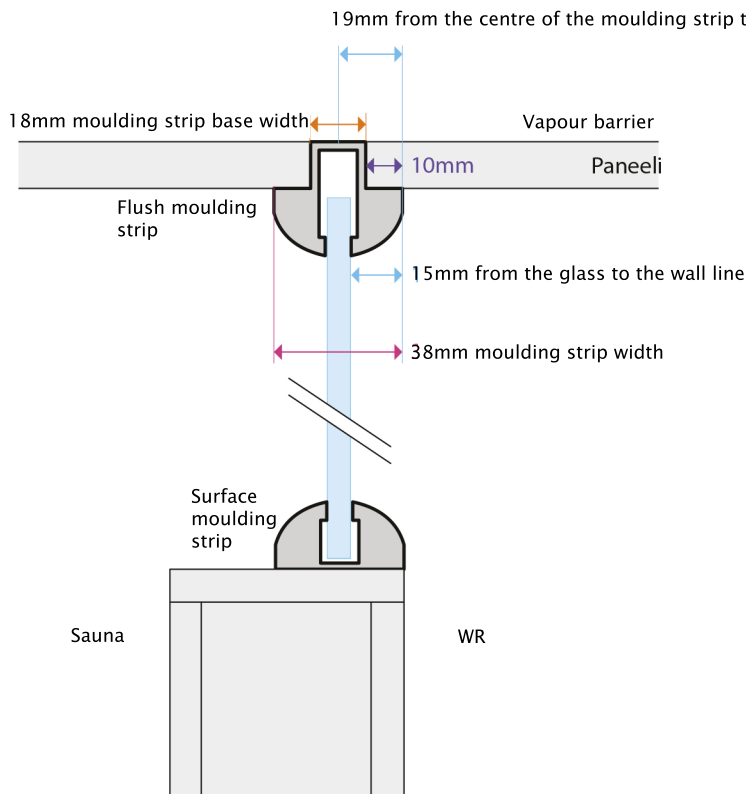

2. Lasiseinän mitoitus

Glass apertures are measured from the finished tile surface and the panel surface (can also be measured from the vapour barrier, as long as the panel thickness is subtracted). Apertures must be rectangular and horizontal/vertical. .

Dimensions required

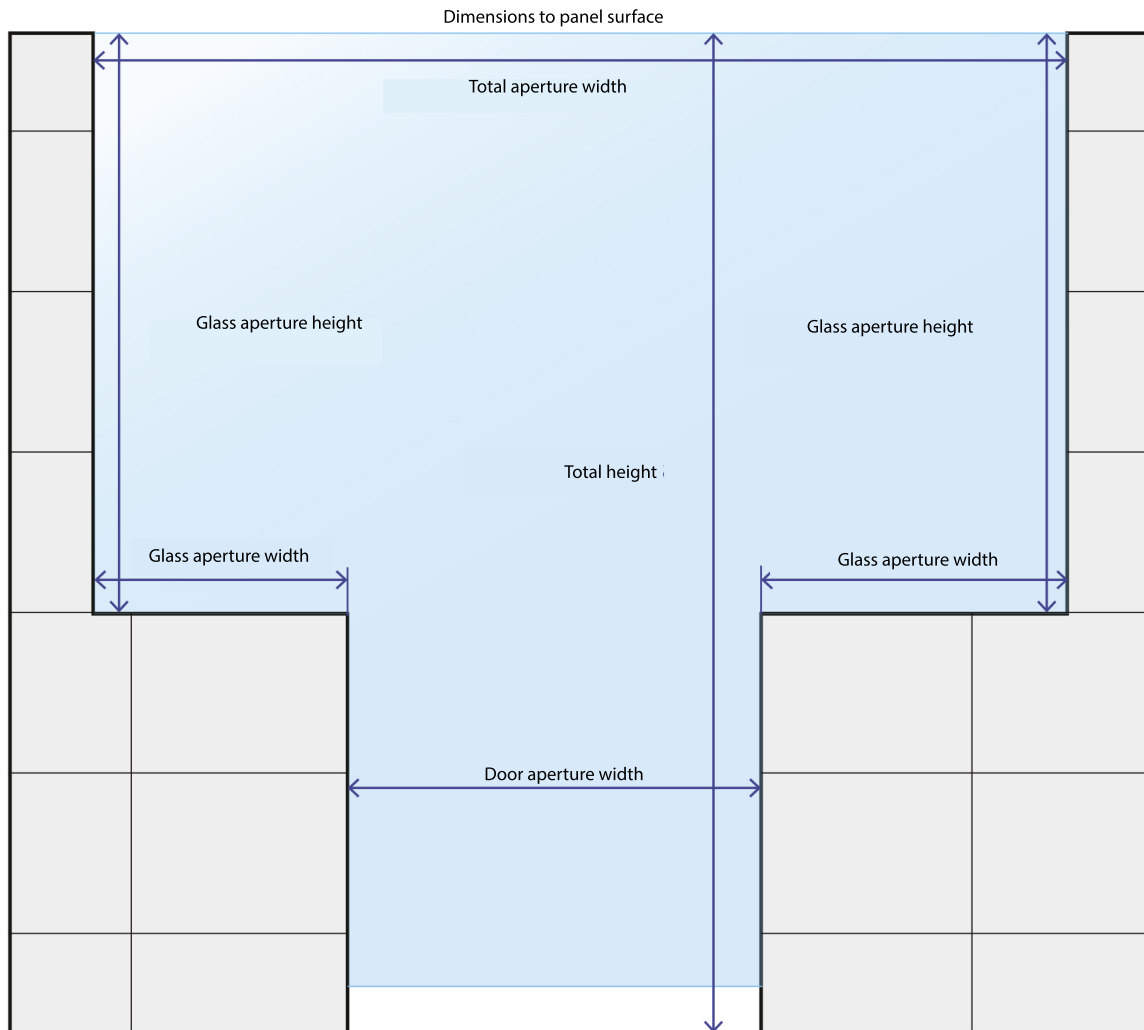

The actual dimensions of the glass supplied are:

- side glazing, aperture width -10mm, height -15mm
- Upper door glazing, door aperture width -4mm
- door, door aperture width -10mm

Gap tolerances

- Aperture width ± 2 mm, aperture height ± 4 mm

Attention! The moulding strips are cut to the indicated apertures. If the apertures deviate from the indicated dimensions, shorter/longer mouldings are required. The mouldings can be shortened with a normal small-tooth crowbar.

3. Installing a glass wall

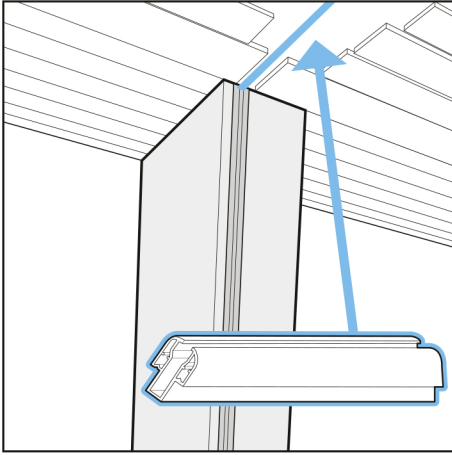

1. Drill holes in the bottom of the top moulding (flush moulding) for the fixing screws where it is to be fixed to the vapour barrier timbers, or at a pitch of about 600mm if the vapour barrier timber is integrated.

If the upper moulding continues over the top of the side moulding, attach an aluminium corner bracket to the end of the upper moulding before installing the moulding (one corner bracket per corner).

Fix the moulding so that the outer edge of the moulding is flush with the tiled surface of the washroom.

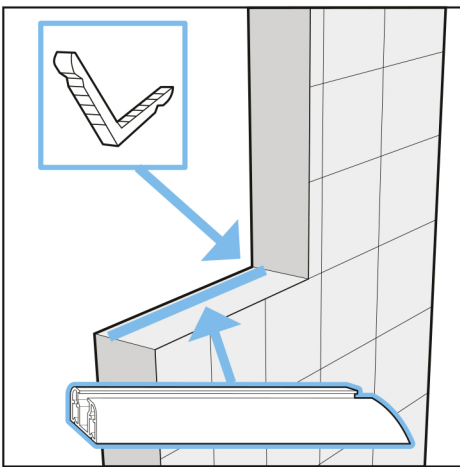

2. Install the other mouldings in place. First the vertical mouldings and then the lower mouldings.

The mouldings are fixed to the tile surface either with mounting adhesive or with prop and screws.

Remember the corner joints where the mouldings meet.

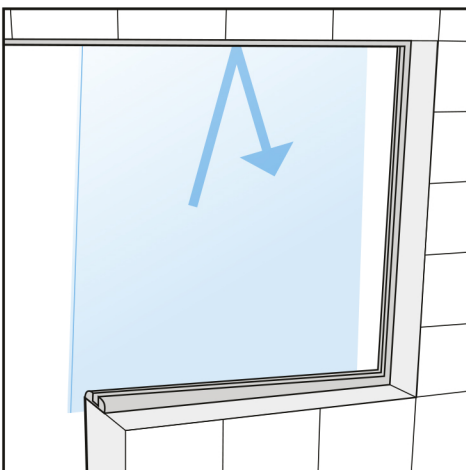

3. Install the side glass panel(s). The bottom moulding should first be fitted with 2 plastic protective/spacer pieces per panel.

Slide the upper edge of the glass into the groove of the upper moulding and lower the lower edge over the spacer pieces in the groove of the lower moulding.

Move the glass sideways so that the edge of the glass is flush with the end of the lower moulding

Attention! Do not knock the edges of the glass.

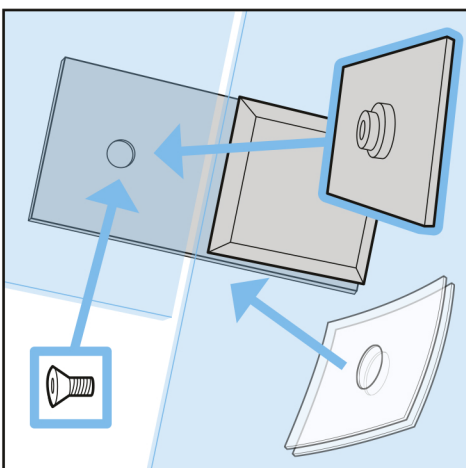

4. Next, install the upper glazing of the door aperture. First attach the glass brackets to the side glass (or to the wall if there is no side glass) When fixing to the wall, first check the position of the fixing hole in the glass on the other side of the side glass.

Fasten the glass to the brackets using nuts and screws.

Place the blue or black gaskets provided in the package in between on both sides of the glass.

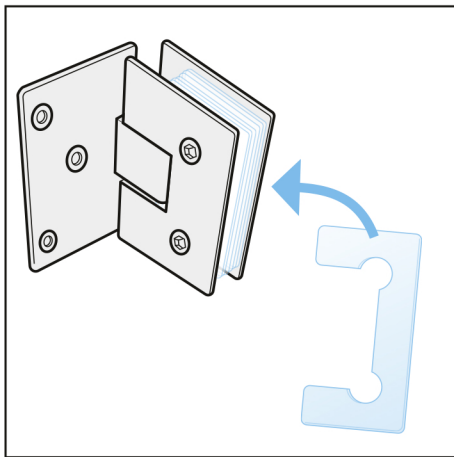

5.. Install the door (and panel).

First attach the hinges to the wall and side glazing, if applicable. The locations of the hinges are shown in the drawing on the next page. The positions can also be determined by attaching the hinges to the door and using the door in place and marking the positions of the hinges.

The wall hinge is installed with the mounting flange facing the sauna. When installing the hinge on the side glass, make sure that the hinge is facing the right way, i.e. the pivoting part of the hinge faces the door. A gasket should be placed on both sides of the glass. Use the black or blue gasket provided in the hinge package. One seal for each side of the glass.

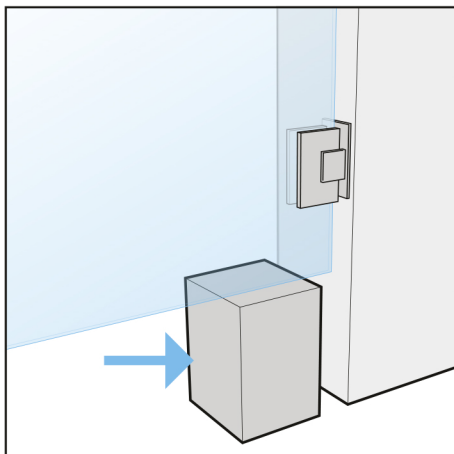

Remove the glass fixing clips from the hinges and lift the door into place. If necessary, use a spacer under the door, e.g. a piece of wood. Attach the fixing flanges, remember the gaskets! Before final tightening, check the clearance between the door and the walls and other glass and change the position of the glass if necessary. Finally, tighten the screws well. Retighten the screws 1-2 weeks after installa-

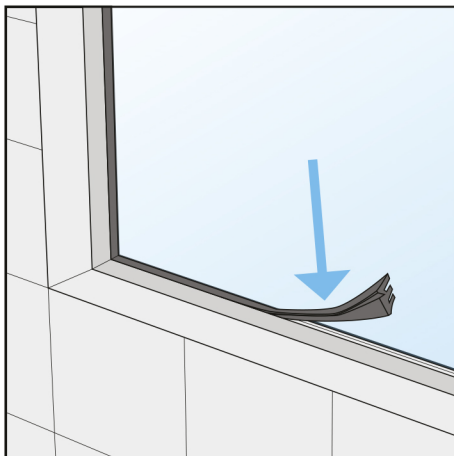

6. Install the glass seals

Install the seals on one side first. Cut the seal at the corners to a 45-degree angle. Do not stretch the seal lengthwise. Cut the seal to be flush with the end of the moulding.

Use wooden wedges and soapy water to help you install the gasket on the other side. Press the seal in place using a blunt object.

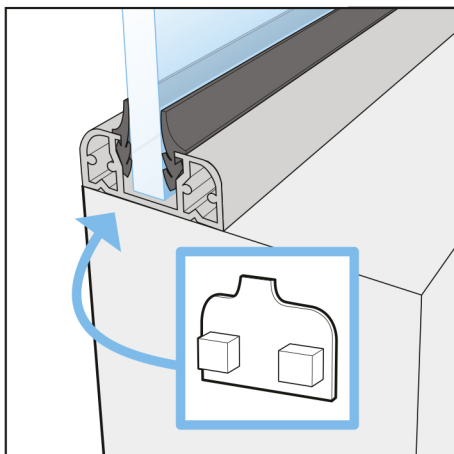

7. Carefully tap the end pieces into the ends of the mouldings.

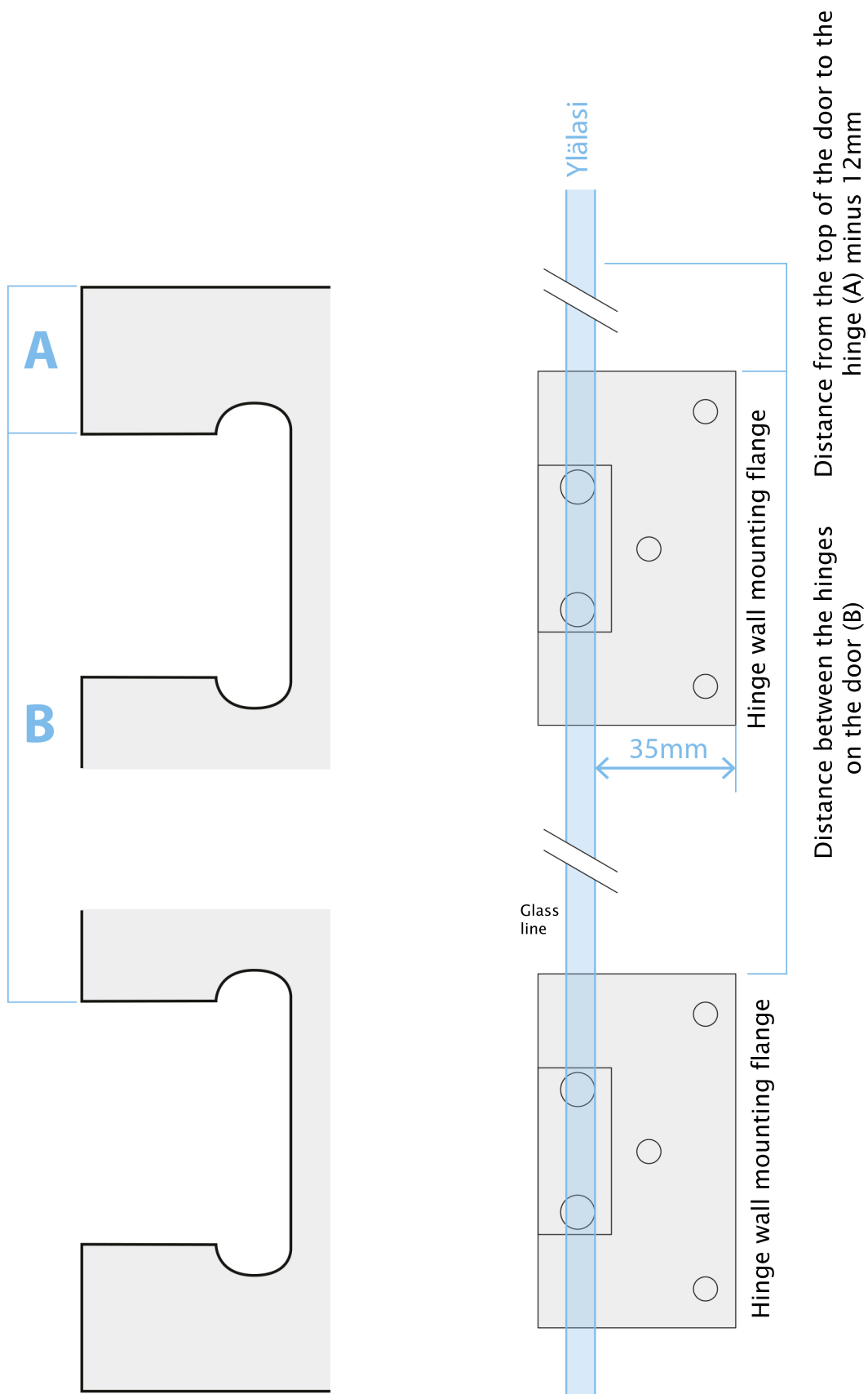

Lining up adjustments

The hinge is adjusted on the sauna side by loosening the screw in the middle of the hinge and turning the door leaf. Loosen the screws on all hinges so that there is no resistance when turning the door. However, it is not necessary to remove the screw. Turn the door leaf in line with the side glass. Then tighten the adjusting screw. Tighten the adjusting screws, even if the actual centring is not necessary.

Glass wall maintenance instructions

Sun Sauna recommends a clay-based cleaner for cleaning glass walls. The cleaner can be purchased from Sun Sauna or other specialist shops. The detergent consists of soap and finely divided polishing clay.

Rub a moistened sponge a few times on the surface of the cleaning agent in the jar and squeeze the sponge until it foams well.

Use a foamy sponge to wash the surface of the glass wall and rinse off the foam with running water or wipe with a damp cloth. If necessary, repeat the washing, especially if the surface of the glass wall has accumulated more limescale.

Polish the glass with a dry cloth or paper towel. After use, allow the detergent to dry and close the lid.

